

Kerry County Council Operations Design Office

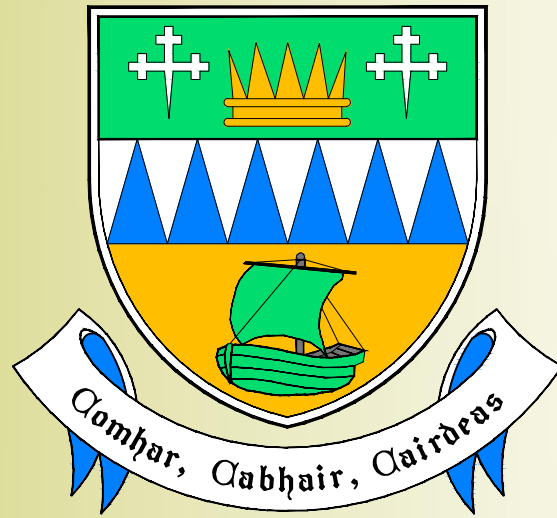

Barraduff NS Pedestrian Crossing Section 38 (171014)

Operations, Capital Infrastructure & Safety Section, Kerry County Council, Rathass, Tralee, Co. Kerry
Telephone (066) 7183588. Facsimile (066) 7129764. E-Mail - roads@kerrycoco.ie

**Kerry County Council
Operations Design Office**

**Barraduff Pedestrian Crossing
Section 38**

(171014)

DRAWING INDEX:

17104-100	COVER
17104-101	INDEX
17104-102	LOCATION PLAN
17104-103	EXISTING LAYOUT
17104-104	PROPOSED LAYOUT

Barraduff NS Pedestrian Crossing
Section 38
Location Plan
(171014)

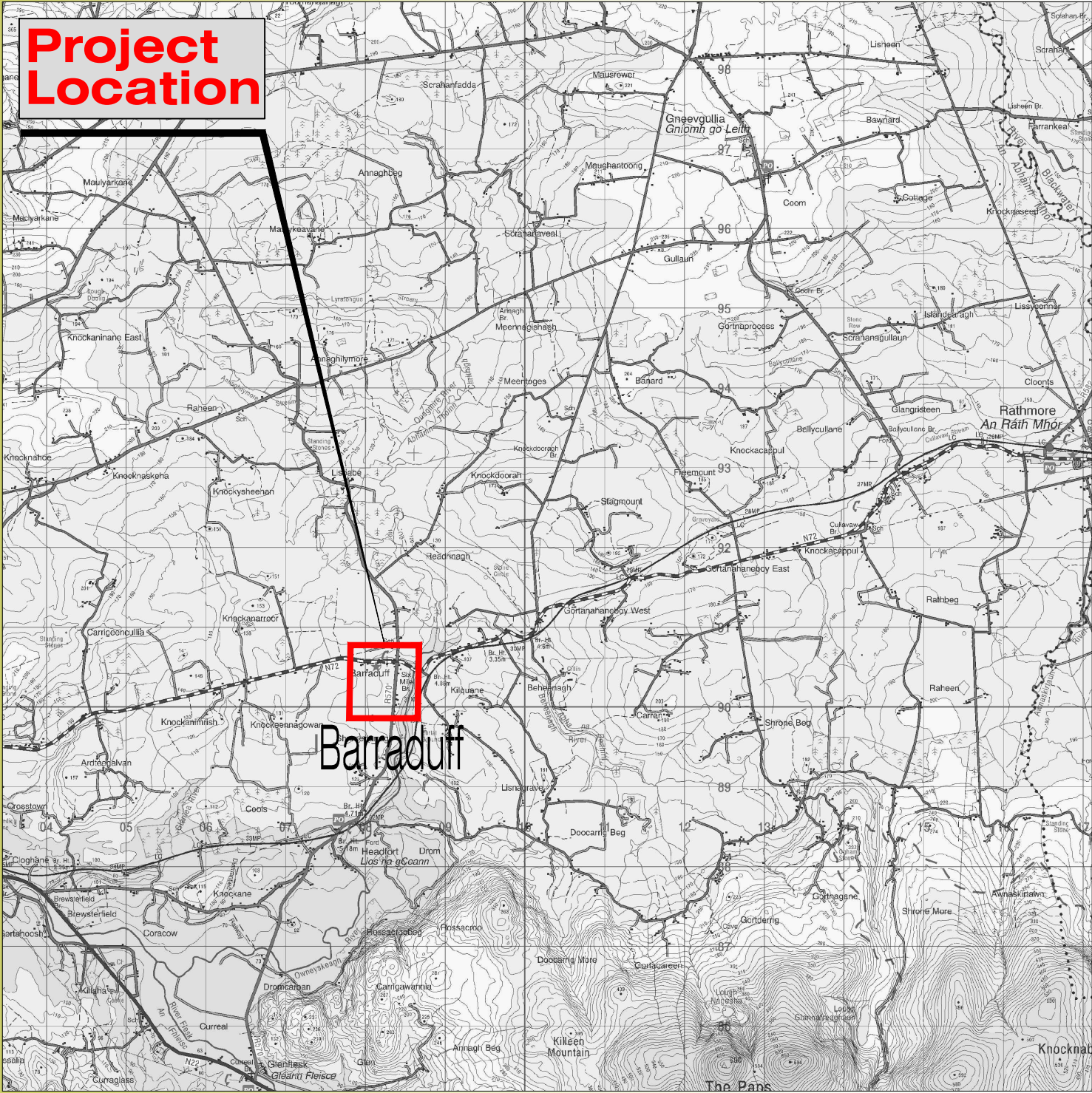

Overview Map

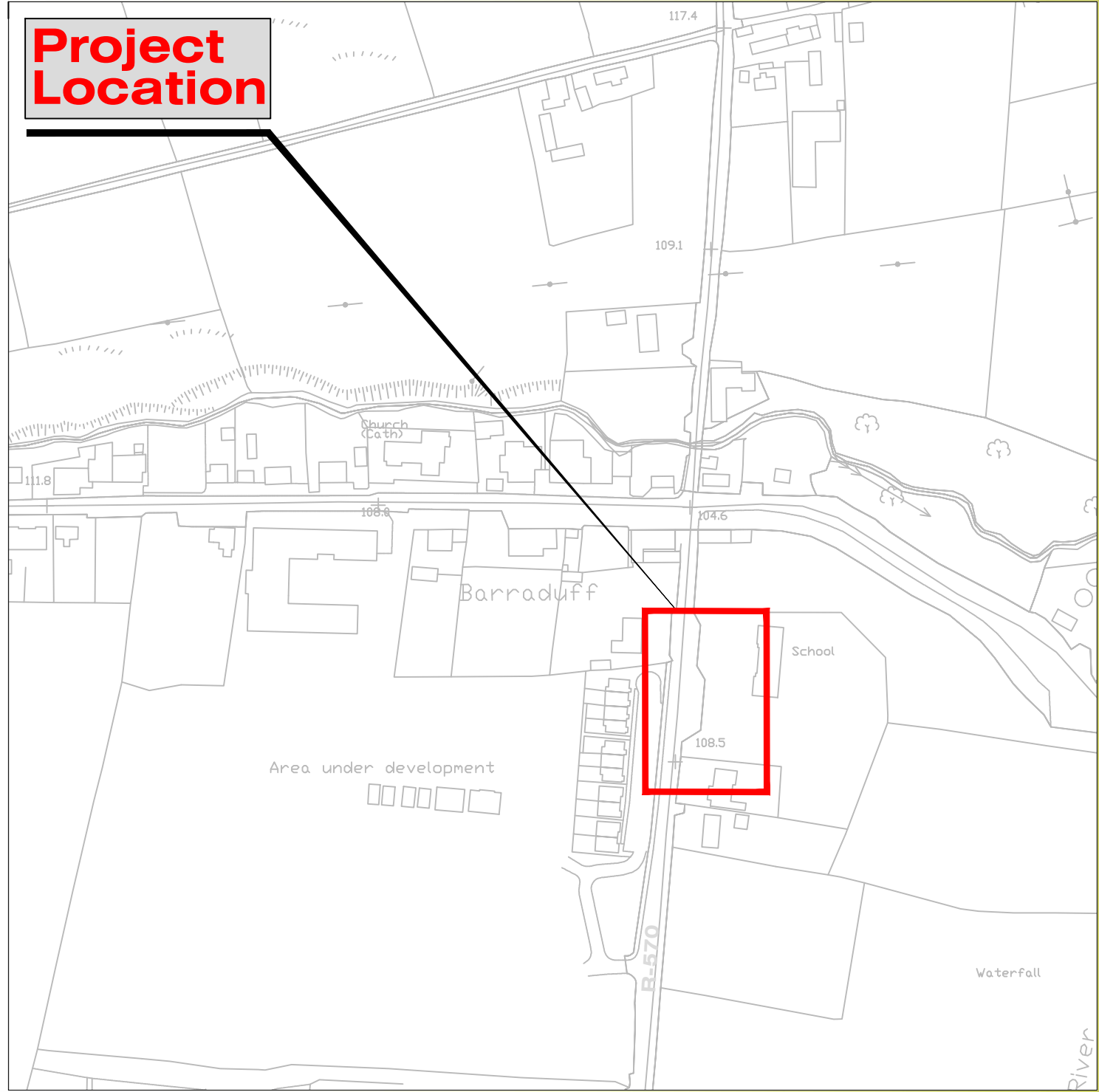

Detail Map



KERRY COUNTY COUNCIL
OPERATIONS DESIGN OFFICE

Charlie O' Sullivan,
B.E., M.Eng., C.Eng., Eur. Ing., M.I.E.I.
DIRECTOR OF SERVICES
OPERATIONS, CAPITAL INFRASTRUCTURE
& SAFETY

David Doyle
B.E.
SENIOR ENGINEER
OPERATIONS, CAPITAL INFRASTRUCTURE
& SAFETY

- (a) This Map is based on National Grid
(b) All Altitudes indicated are in Metres, and are referred to Ordnance Datum, which is Mean Sea Level at Malin Head, Co. Donegal (1970 Adjustment).
(c) These Maps are used under The Licensing Agreement between the Ordnance Survey Ireland and the County and City Managers
(d) For Section 38 purposes only

Rev	Description	Reviewed	Approved	Date
S01	Issued to SMT for Approval	T.O.C	P.O.R.	28/02/17

Project Name: Barraduff NS Pedestrian Crossing:-Clár Funding		Job No. 171014
Title: Location Map		Drawn No. 102
Designed: T.O'Carroll	File Name: P12017/Clár Funding/171014/001 Drawings/102.dwg	
Drawn: A. Kieman	Original scale: NTS@A3-Do NOT Scale-Use Figured Dimensions Only	
Checked: P. O'Rourke	Date: February 2017	

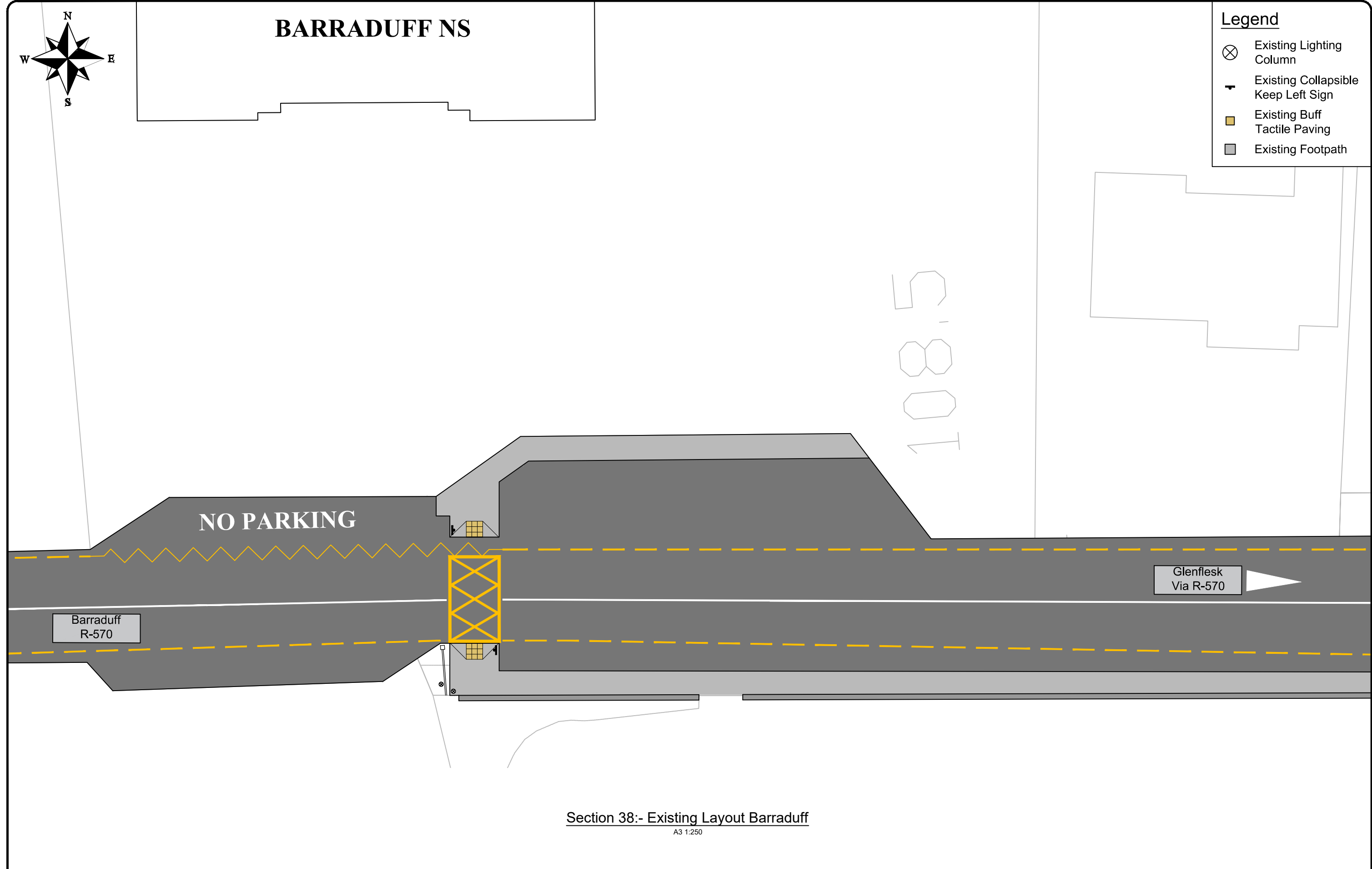

Section 38:- Existing Layout Barraduff
A3 1:250



KERRY COUNTY COUNCIL
OPERATIONS DESIGN OFFICE

Charlie O'Sullivan,
B.E., M.Eng., C.Eng., Eur.Ing., M.I.E.I.
DIRECTOR OF SERVICES
OPERATIONS, CAPITAL INFRASTRUCTURE
& SAFETY

David Doyle
B.E.
SENIOR ENGINEER
OPERATIONS, CAPITAL INFRASTRUCTURE
& SAFETY

(a) This Map is based on National Grid
(b) All Altitudes indicated are in Metres, and are referred to Ordnance Datum, which is Mean Sea Level at Malin Head, Co. Donegal (1970 Adjustment).
(c) These Maps are used under The Licensing Agreement between the Ordnance Survey Ireland and the County and City Manager's
(d) For Section 38 purposes only

Rev	Description	Reviewed	Approved	Date
S01	Issued to SMT for Approval	T.O'C.	P.O'R.	28/02/17

Project Name: Barraduff NS Pedestrian Crossing:-Clár Funding		Job No: 171014
Title: Existing Layout	File Name: P:2017/Clár Funding\171014\001 Drawings\103.dwg	Drawn By: 103
Designed: T.O'Carroll	Original Scale: 1:250@A3-Do NOT Scale-Use Figured Dimensions Only	
Drawn: A. Kieman	Date: February 2017	
Checked: P. O'Rourke		

BARRADUFF NS

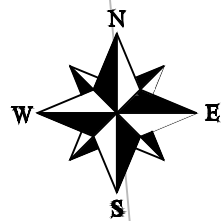

Legend

- Existing Lighting Column
- Existing Collapsible Keep Left Sign
- Proposed Red Tactile Paving
- Existing Footpath
- Proposed Flashing Amber Beacon
- Proposed Build-Out
- Proposed Bollard

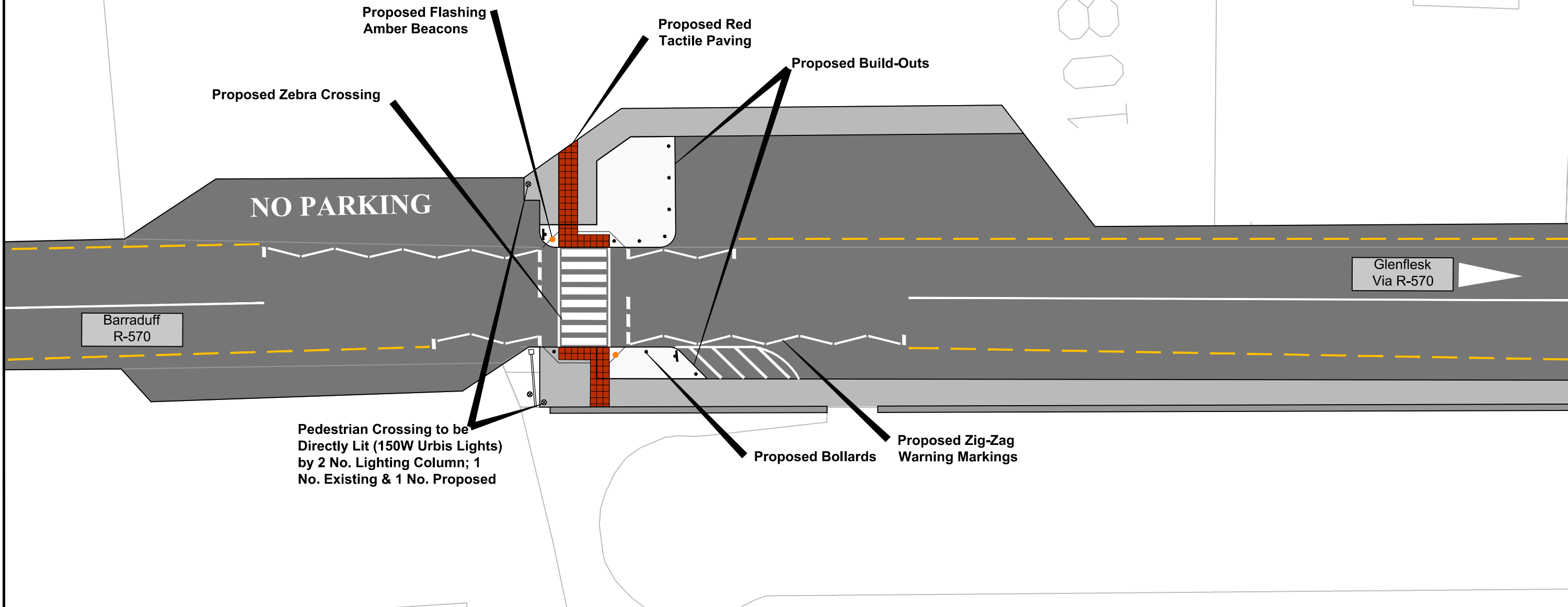

KERRY COUNTY COUNCIL
OPERATIONS DESIGN OFFICE

Charlie O'Sullivan,
B.E., M.Eng., C.Eng., M.I.E.I.
DIRECTOR OF SERVICES
OPERATIONS, CAPITAL INFRASTRUCTURE
& SAFETY

David Doyle
B.E.
SENIOR ENGINEER
OPERATIONS, CAPITAL INFRASTRUCTURE
& SAFETY

- (a) This Map is based on National Grid
- (b) All Altitudes indicated are in Metres, and are referred to Ordnance Datum, which is Mean Sea Level at Malin Head, Co. Donegal (1970 Adjustment).
- (c) These Maps are used under The Licensing Agreement between the Ordnance Survey Ireland and the County and City Manager's
- (d) For Section 38 purposes only

Rev	Description	Reviewed	Approved	Date
S01	Issued to SMT for Approval	T.O'C.	P.O'R.	28/02/17

Project Name: Barraduff NS Pedestrian Crossing:-Clár Funding		Job No. 171014
Title: Proposed Layout	File Name: P:2017/Clár Funding\171014\001 Drawings\104.dwg	Drawn By: 104
Designed: T.O'Carroll	Original Scale: 1:250@A3-Do NOT Scale-Use Figured Dimensions Only	
Drawn: A. Kieman	Date: February 2017	
Checked: P. O'Rourke		