



LEGEND:

- Proposed Carriageway
- Proposed Footpath/Cycleway
- Proposed Verge
- Existing Footpath (to be maintained)
- Proposed Retaining Wall
- Proposed Timber Post and Tension Mesh Fence to CC-SCD-00320
- Proposed Wall
- Existing Wall (to be retained)
- Temporary acquisition line (proposed retaining walls)

LONGITUDINAL PROFILE
(Scale H 1:1000/V 1:100)

Level Datum =4,000

DESIGN LEVELS	10.892 - 13.048
EXISTING LEVELS	10.879 - 13.034
Horizontal Sch.	
Vertical Scheme	
Chainage	670,000 - 1440,000

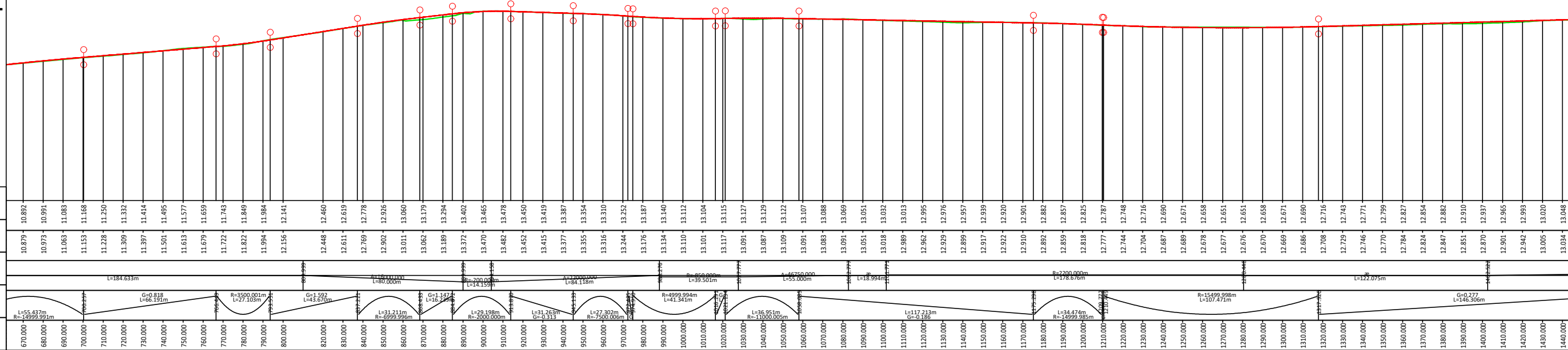

Includes Ordnance Survey Ireland Licence number EN 0005019 © Ordnance Survey Ireland / Government of Ireland

Client

KERRY COUNTY COUNCIL
KERRY NATIONAL ROAD DESIGN OFFICE.
THE ISLAND CENTRE,
CASTLEISLAND,
CO. KERRY.

Kerry NRDO
National Road Design Office
Gúgú Doortha um Bóthar Náisiúnaí Chaisle

General Notes

(i) Hard copies, dwf and pdf will form a controlled issue of the drawing. All other formats (dwg etc.) are deemed to be an uncontrolled issue and any work carried out based on these files is at the recipient's own risk. RPS will not accept any responsibility for any errors from the use of these files, either by human error by the recipient, listing of the un-dimensioned measurements, compatibility with the recipient's software, and any errors arising when these files are used to aid the recipient's drawing production, or setting out on site.

(ii) DO NOT SCALE, use figured dimensions only.

(iii) This drawing is the property of RPS, it is a project confidential classified document. It must not be copied used or its contents divulged without prior written consent. The needs and expectations of client and RPS must be considered when working with this drawing.

(iv) Information including topographical survey, geotechnical investigation and utility detail used in the design have been provided by others.

(v) All Levels refer to Ordnance Survey Datum, Malin Head.

rps MAKING COMPLEX EASY

Innishmore, Ballincollig, Co. Cork, Ireland
T +353 21 4665900
W www.rpsgroup.com/ireland
E ireland@rpsgroup.com

Scale	As shown @ A1 Half @ A3	Project	N72 Killorglin to Anglont Road Improvement Scheme
Created on	Oct.'19	Title	Plan and Longitudinal Profile
Sheets	02 of 4	File Identifier	MCT0770-RPS-00-XXX-XR-C-DG0002 - 02
Rev	Date	Amendment / Issue	App
P01	Oct.'19	Work in Progress	LB
Model File Identifier	MCT0770-RPS-00-XXX-XR-C-DG0002	Status	S0
Rev	P01		

R:\MCT0770 - N72 Killorglin Approach\0 - Drawings\WORK\MCT0770-RPS-00-XXX-XR-C-DG0002.dwg